

## MORING ROAD, TOOTING BEC, SW17



Walker Wyatt are delighted to offer to the market this very spacious one double bedroom second floor apartment. This property is presented to the market in good decorative order. Other benefits include fitted kitchen and bathroom, good storage, and allocated gated off street parking.

Moring Road, running between Franciscan Road and Church Lane, is ideally located close to Tooting Bec Northern Line Underground Station and excellent shopping facilities. The benefits of Tooting Bec Common and the local shops on Franciscan Road are also only moments away.

**ACCOMMODATION: One Double Bedroom: Reception Room: Kitchen: Bathroom:  
G.F.C.H: Off street parking**

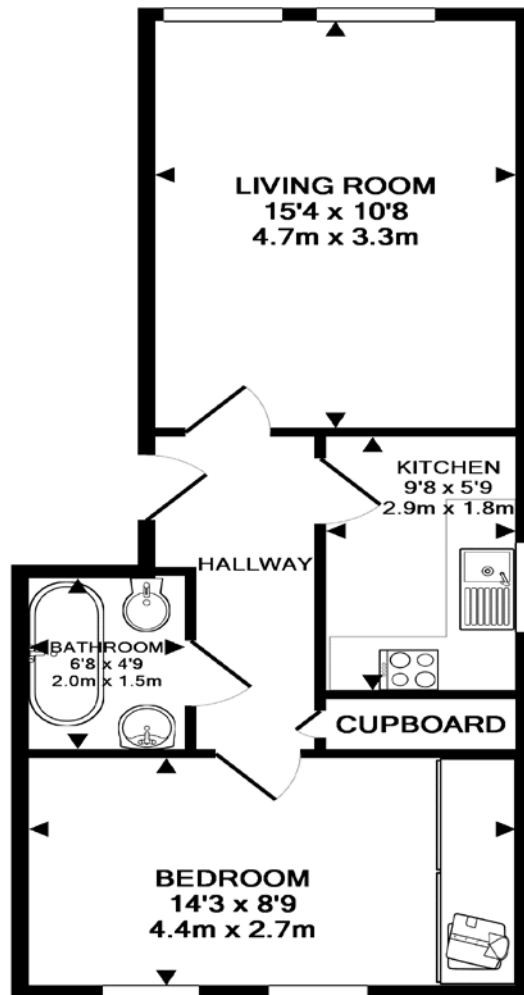

Whilst every attempt has been made to ensure the accuracy of the floor plan contained here, measurements of doors, windows, rooms and any other items are approximate and no responsibility is taken for any error, omission, or mis-statement. This plan is for illustrative purposes only and should be used as such by any prospective purchaser. The services, systems and appliances shown have not been tested and no guarantee as to their operability or efficiency can be given  
Made with Metropix ©2010

LONDON BOROUGH OF WANDSWORTH

PRICE - £219,950 – SHARE OF FREEHOLD